



取扱説明書
Operation Manual
Manuel d'utilisation
Bedienungsanleitung
 操作手册
Manuale delle istruzioni
Manual de funcionamiento
Manual de funcionamiento

還元水・強酸性水連続生成器
Continuous Ionized KANGEN and Strong Acidic Generator
Générateur continu d'eau ionisée KANGEN et d'Eau Fortement Acide
Generator für kontinuierlich ionisiertes KANGEN- und stark saures Wasser
 还原水・强酸性水连续生成器
Generatore continuo di acqua ionizzata KANGEN e super acida
Generador continuo de Agua KANGEN y Agua Acida Fuerte
Ionizado Continuo KANGEN e Gerador de Água Acidulada Forte

Product name : **LevelLuk KANGEN8**

このたびは< LevelLuk KANGEN8 >をお買い上げいただき、まことにありがとうございます。この製品の機能をいかして上手にお使いいただくため、ご使用前にこの「取扱説明書」をよくお読みいただき、大切に保管してください。

Thank you very much for purchasing our < LevelLuk KANGEN8 >. Please read through the Operation Manual carefully for your safety before using the product. Please keep this manual in a safe place for future use.

Merci pour votre achat du < LevelLuk KANGEN8 >. Veuillez lire attentivement le manuel d'utilisation pour votre sécurité avant d'utiliser le produit. Veuillez conserver ce manuel en lieu sûr en vue sa consultation ultérieure.

Vielen Dank für den Kauf unseres < LevelLuk KANGEN8 >.
 Bitte lesen Sie diese Bedienungsanleitung sorgfältig durch, um dieses Produkt sicher benutzen zu können. Bitte bewahren Sie diese Bedienungsanleitung für späteres Nachschlagen an einem sicheren Ort auf.

谢谢购买我们产品< LevelLuk KANGEN8 >, 为了您充分发挥本产品的功能, 使用之前请您好好阅读本使用说明书并予以妥善保管备用为盼。

Vi ringraziamo per aver acquistato < LevelLuk KANGEN8 >.
 Per la vostra sicurezza, leggete attentamente e in tutte le sue parti il manuale d'uso prima di utilizzare il prodotto. Conservate questo manuale in un luogo sicuro per poterlo consultare in futuro.

Muchas gracias por adquirir nuestro < LevelLuk KANGEN8 >.
 Favor de leer el manual de operación cuidadosamente por su seguridad antes de utilizar el producto. Favor de guardar este manual en un lugar seguro para uso futuro.

Muito obrigado por ter comprado nossos < LevelLuk KANGEN8 >.
 Por favor, leia integral e cuidadosamente o Manual de Operação para a sua segurança antes de usar o produto. Mantenha este manual num local seguro para referência futura.

日本語	JP1
English	EN1
Français	FR1
Deutsch	DE1
简体中文	CH1
Italiano	IT1
Español	ES1
Português	PO1

ロサンゼルス Los Angeles

4115 Spencer Street Torrance CA 90503 U.S.A.
tel.(1)310-542-7700 fax.(1)310-542-1700

ニューヨーク New York

36-36 33rd St.4th Floor Suite 403, Astoria, NY 11106 U.S.A.
tel.(1)718-784-2110 fax.(1)718-784-2103

シカゴ Chicago

1154 S. Elmhurst Rd. Mount Prospect, IL 60056 U.S.A.
tel.(1)847-437-8200 fax.(1)847-437-8201

テキサス Texas

739 Justin Road, Rockwall, TX 75087 U.S.A.
tel.(1)972-722-7499 fax.(1)972-722-7402

フロリダ Florida

8803 Futures Drive, Unit01, Orlando, FL 32819 U.S.A.
tel.(1)407-601-5963 fax.(1)407-730-3335

シアトル Seattle

19009 33rd Avenue, W., suite 201, Lynnwood, WA 98036 U.S.A.
tel.(1)425-640-2222 fax.(1)425-672-8946

ホノルル Honolulu

Ala Moana Pacific Center, Suite 711, 1585 Kapiolani Boulevard,
Honolulu, Hawaii 96814 U.S.A.
tel.(1)808-949-5300 fax.(1)808-949-5336

バンクーバー Vancouver

Suite 678-5900 NO.3 Road Richmond, BC V6X 3P7, Canada
tel.(1)604-214-0065 fax.(1)604-214-0067

トロント Toronto

75 Watline Avenue, Suite 138 Mississauga, ON L4Z 3E5, Canada
tel.(1)905-507-1200 fax.(1)905-507-1233

メキシコ Mexico

Commercial Plaza Tanarah Avenida Vasconcelos 345,
Colonia Santa Engracia 66267
San Pedro Garza Garcia, Nuevo Leon, Mexico
tel.(52)81-8242-5500 fax.(52)81-8242-5549

ドイツ Germany

Immermannstr.33 40210 Düsseldorf Germany
tel.(49)211-9365-7000 fax.(49)211-9365-7027

フランス France

24 rue du Banquier 75013 Paris France
tel.(33)01-4707-5565 fax.(33)01-8371-1706

イタリア Italy

Via roccaparena 40-42 00191 Roma Italy
tel.(39)06-3330-670 fax.(39)06-3321-9505

オーストラリア Australia

15/33 Waterloo Rd Macquarie Park
New South Wales 2113, Australia
tel.(61)2-9878-1100 fax.(61)2-9878-1200

フィリピン Philippines

21st Floor, 6788 Ayala Avenue, Oledan Square, Makati City,
Philippines
tel.(63)2-519-5508 fax.(63)2-519-1923

シンガポール Singapore

111 North Bridge Road, 25-04 Peninsula Plaza Singapore 179098
tel.(65)6720-7501 fax.(65)6720-7505

マレーシア Malaysia

Unit 29-7,7F, The Boulevard Mid Valley City, Lingkaran Syed Putra,
59200, Kuala Lumpur, Malaysia
tel.(60)3-2282-2332 fax.(60)3-2282-2335

インドネシア Indonesia

The Plaza Office Tower 22nd Floor Jl. M.H. Thamrin Kav. 28-30
Jakarta 10350 Indonesia
tel.(62)21-2992-3111 fax.(62)21-2992-8111

香港 Hong Kong

Unit 1615-17, 16th Floor Miramar Tower, 132 Nathan Rd.,
Tsim Sha Tsui, Kowloon, Hong Kong.
tel.(852)2154-0077 fax.(852)2154-0027

台湾 Taiwan

Nanjing East Road, 3-337 12F B Room
Xiong Shan Qu, Taipei City, Taiwan
tel.(886)2-2713-2936 fax.(886)2-2713-2938

韓国 Korea

7F 118-3, Nonhyun-dong Gangnam-gu Seoul, Korea
tel.(82)2-546-8120 fax.(82)2-546-8127

札幌 Sapporo

Regent Building 7F
1-5, Nishi2chome, Kita2jo, Chuo-ku, Sapporo-city, Hokkaido,
Japan 060-0002
tel.(81) 11-223-5678 fax.(81) 11-223-5680

東京 Tokyo

Echizenya Building 7F
1-1-6, Kyobashi Chou-ku, Tokyo, Japan 104-0031
tel.(81) 3-5205-6032 fax.(81) 3-5205-6035

大阪 Osaka

1-1-3 Umeda kita-ku, Osaka, Japan 530-0001
Osaka Station third building 29F
tel.(81) 6-6345-4132 fax.(81) 6-6345-4142

四国 Sikoku

1313-8, Simojimayama-kou, Saijyou-city, Ehime, Japan 793-0006
tel.(81) 897-58-4115 fax.(81) 897-58-4116

福岡 Fukuoka

Bell Commons Hakata Building 3F
2-5-8, Hakataekimae, Hakata-ku, Fukuoka, Japan 812-001
tel.(81) 92-481-4132 fax.(81) 92-481-4142

沖縄 Okinawa

4-10-1, Makiminato Urazoe-city, Okinawa, Japan 901-2131
tel.81-98-878-4132 fax.81-98-878-4141

名護 Nago

1-3-6, Agaria Nago-city, Okinawa, Japan 905-0021
tel.(81) 980-51-0616 fax.(81) 980-51-0628

工場 Factory

1-40-1, Hosida-kita Katano-city, Osaka, Japan 576-0017
tel.(81) 72-893-2290 fax.(81) 72-893-8007



ISO 9001:2008
ISO 13485:2003
Management
System

www.tuv.com
ID 9105070879

Contents

IMPORTANT SAFEGUARDS /	EN 2
SAVE THESE INSTRUCTIONS	
GROUNDING INSTRUCTIONS	EN 3

Introduction	EN 4
Precautions on the use of Beauty water and Strong Acidic water as well as KANGEN water	EN 5
Features	EN 6
Confirming the accessories	EN 7

Name of each part	EN 8
Touch display	EN 9
Installation	EN10
Installing the diverter	EN11
Setting up the unit	EN13
About the power cable	EN15

Setting menu	EN16
•Language / •Voice Guidance Volume	
•Brightness / •Sleep	
Check the filter	EN16

Producing KANGEN water, Clean water, Beauty water.	EN18
•How to measure pH value in KANGEN water	

Strong Acidic water / Strong KANGEN water	EN20
•How to measure pH value in Strong Acidic water	

pH Setting	EN22
Mineral Additive	EN22

About the auto cleaning	EN23
-------------------------	------

Replacing the water filter	EN24
•Guide to replacing the water filter	
•Notification that it is time to replace the water filter	

E-Cleaning	EN27
------------	------

When this display appears	EN29
Troubleshooting	EN31

Safety Precautions	EN32
Options	EN34
Standard Specifications	EN35
After-sales Service	EN36

In this manual

Concerning with “Alkaline electrolytic water” and “Acidic electrolytic water” showing in JIS T2004 “Electrolytic water generator for household use”, we use the technical term of “KANGEN water” and “Beauty water”.

IMPORTANT SAFEGUARDS

• READ ALL INSTRUCTIONS BEFORE USING:

DANGER – To reduce the risk of electrocution:

1. Always unplug this product immediately after using.
2. Do not use while bathing.
3. Do not place or store product where it can fall or be pulled into a tub or sink.
4. Do not place in or drop into water or other liquid.
5. Do not reach for a product that has fallen into water. Unplug immediately.

WARNING – To reduce the risk of burns, electrocution, fire, or injury to persons.

1. A product should never be left unattended when plugged in.
2. Close supervision is necessary when this product is used by, on, or near children or invalids.
3. Use this product only for its intended use as described in this manual. Do not use attachments not recommended by the manufacturer.
4. Never operate this product if it has a damaged cord or plug, if it is not working properly, if it has been dropped or damaged, or dropped into water. Return the product to a service center for examination and repair.
5. Keep the cord away from heated surfaces.
6. Never use while sleeping or drowsy.
7. Never drop or insert any object into any opening or hose.
8. Do not use outdoors or operate where aerosol (spray) products are being used or where oxygen is being administered.
9. Connect this product to a properly grounded outlet only. See Grounding Instructions.

SAVE THESE INSTRUCTIONS

- a) This manual contains instructions for cleaning, user maintenance, and proper operations recommended by the manufacturer such as lubrication, and non-lubrication of this device. All services required by this product must be performed by an authorized service representative, which means that this product contains no user serviceable parts. This product is for household use as stated in this manual and other literature packed with the product.
- b) When a product employing an automatic reset thermal limiter (which shuts off the entire product) is used, please refer to this manual for instructions and warnings.
- c) While the product is in use, please refer to this manual for proper cord maintenance.
- d) The product is intended to be used with water, additives, conditioners, or a product that relies on the conductivity of water for normal operations (electrode type products). The use of baking soda, salt, or other substances to improve the conductivity of the water is stipulated.
Please refer to this manual for specific instructions on the proper liquid or additive and the exact amount to be used in conjunction with the product.

GROUNDING INSTRUCTIONS

This product should be grounded. In the event of an electrical short circuit, grounding reduces the risk of electric shock by providing an escape wire for the electric current. This product is equipped with a cord having a grounding wire with a grounding plug. The plug must be plugged into an outlet that is properly installed and grounded.

DANGER – Improper use of the grounding plug can result in a risk of electric shock.

If repair or replacement of the cord or plug is necessary, do not connect the grounding wire to either flat blade terminal. The wire with insulation having an outer surface that is green with or without yellow stripes is the grounding wire. Check with a qualified electrician or serviceman if the grounding instructions are not completely understood, or if in doubt as to whether the product is properly grounded.

For all other grounded, cord connected products:

This product is equipped with an interchangeable power cord to permit connection with all types of electrical power. (100v-240v) 50-60Hz. Make sure the plug and consent have the same configuration. Do not use adapters with this product. If it will not fit, contact the distributor from whom you purchased this machine from to acquire the correct power plug.

Extension Cords:

If it is necessary to use an extension cord, use only a three wire extension cord that has a three-blade grounding plug, and a three-slot receptacle that will accept the plug on the product. Replace or repair a damaged cord.

Introduction

Indicators used in this manual

The marks in this manual indicate areas of importance, and are explained below. Be sure to read the Warning and Caution instructions carefully.

Level of danger



Warning

Indicates an imminently hazardous situation which may result in health hazards if the device is handled in a manner other than described in this manual.



Attention

Indicates a potentially hazardous situation which may result in minor or moderate injury if the device is handled in a manner other than described in this manual.

- * All the precautions described here are classified as " ⚠ Warning" and " ⚠ Attention". Any potential hazardous situation which could result in death or serious physical injury are referred to under the sign " ⚠ Warning". However, other potentially hazardous situations referred to under the sign of " ⚠ Attention" can also present serious danger, depending on the case and situation. All the precautions, therefore, should be strictly followed.
- * The maker of this product is not responsible for any damage to the product or accidents caused by improper use or by disregarding the precautions mentioned in this manual.
- * After reading this manual, please keep it in a safe place for future reference.

Description of signal marks

Mark	Title	Significance
	General	Used to indicate general precautions, warnings and dangers.
	General	Used to notify general prohibition precautions, warning and danger.
	General	Used to describe behavior of general users.
	Open flames	Used to warn against any behavior that could result, under certain conditions, in the unit catching fire as a result of proximity to flame.
	Prohibition of use at water splashing place, such as, bath or shower room.	Used to prohibit use of the product through using near baths or in showers, or any place where the unit may come in contact with water, the unit is not waterproof.
	Disassembly	Used to warn against self-repair or taking apart the unit by oneself, which could cause electric shock or other injuries.
	Unplugging	Used to indicate to the user when it is necessary to unplug the product, especially when it is showing signs of being damaged, or when a thunderstorm is expected.

Precautions on the use of Beauty Water and Strong Acidic Water as well as KANGEN Water

Warning - Please observe carefully -



Please observe

- Please consult with your physician before using Beauty Water or Strong Acidic Water if you have any of the following.
 - Sensitive skin
 - Allergies
- If you experience any skin irritation after using Beauty Water, discontinue use and consult with your physician.
- Please take the following precautions prior to drinking KANGEN Water:
 - Do not take medication with KANGEN Water.
 - Do not drink KANGEN Water if you have kidney problems such as kidney failure or trouble processing potassium.
 - If you experience any discomfort please discontinue use and consult with your physician.
 - If you are under the care of a physician please consult with them prior to drinking KANGEN Water.
 - Do not use KANGEN Water with baby formula or baby foods.

Attention



Prohibited

- Do not drink any of the following types of water; they may negatively affect your health.
 - Strong Acidic Water
 - Beauty Water
 - Cleaning cycle water
 - Water containing pH test liquid
 - Strong KANGEN Water during the production of Strong Acidic Water
 - Water being discharged from the secondary water hose
- When drinking KANGEN Water, adjust the pH value to 9.5 or lower. It is not recommended to drink water with a pH over 10.0. Check the pH regularly.
- Please drink the KANGEN Water as soon as possible after it is made.
- Do not use KANGEN or Beauty Water in fish bowls or aquariums; changes in pH may kill the fish.
- Do to the fact that copper containers are acid-sensitive and aluminum containers are alkaline-sensitive they should not be used.



Please observe

- Use containers made of glass, plastic, ceramic, or other non-corrosive materials when storing Strong Acidic Water. Metal containers will corrode when in contact with Strong Acidic Water and should never be used.
- Store Strong Acidic Water in a tightly sealed container that is impermeable to light. Use stored contents within one week.
- Metal knives or spoons cleaned with Strong Acidic Water or Beauty Water must be dried. Rust can develop if the utensils are left wet.
- Store KANGEN Water in a sealed container and keep refrigerated. Use the contents within 3 days.
- Run water through the machine for 15 minutes when you first use a new filter.
- Let the water flow for more than 10 seconds before your first use of the day.
- If the unit has been unused for 2-3 days, let the water flow for more than 30 seconds.
- Please follow local laws and regulations when disposing of used filters.

Features

- This product is capable of producing 5 types of water, “Strong Acidic Water”, “Strong KANGEN Water”, “KANGEN Water”, “Beauty Water”, and “Clean Water”. All at a touch of the button to suit your specific needs.

1 Set the lever of the diverter to ion position.

2 Select the mode and tap the button.

3 Open the water supply faucet.

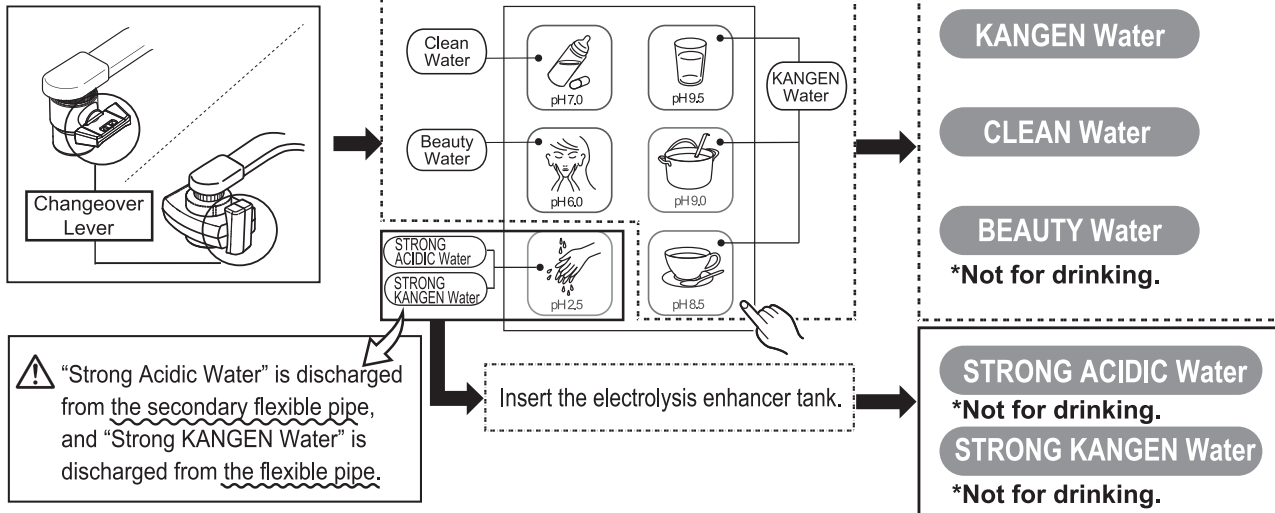

- 5 type of water, subdivided into 7 according to pH, are available to suit your specific need.

Processed water	button	pH level	Use	! ATTENTION
KANGEN Water		pH 9.5	For everyday drinking Is best for ordinary drinking water, or for making coffee, black tea, oolong tea, and so on.	Not to be used with medicine. When taking medicine, select the CLEAN WATER mode.
		pH 9.0	Once you have become used to drinking KANGEN water Drawing out the flavor of ingredients, food doesn't need as much seasoning, and excess salt can be avoided.	
		pH 8.5	Your Starting Point This pH level is recommended for people to get used to KANGEN Water.	
CLEAN Water		pH 7.0	To be taken with medicine or preparing baby formula The clean water can be used as water to be taken with medicine as well as water you can drink every day.	—
BEAUTY Water		pH 6.0	For your skin care To be used as astringent water, bath water.	
STRONG ACIDIC Water		pH 2.5	To be used as disinfectant or cleaning This water washes clean your kitchen utensils such as cooking knives, cooking boards, and washes cups and saucers stain-free. It also destroys pathogenic bacteria on fruit.	Not for drinking.
STRONG KANGEN Water		pH 11.0	Has the power to dissolve tough stains Use the added power of STRONG KANGEN Water to remove tough kitchen grease stains or cleaning floors. Use to wash fish, meat and vegetables.	

! Warning



When producing STRONG ACIDIC Water, please make sure the room is well ventilated and avoid prolonged breathing of the vapors.

Confirming the accessories

If you find anything wrong with the product, please contact the distributor from whom you purchased it.

About installation

- Power cord

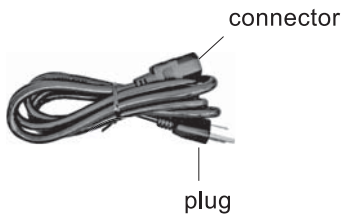

- Operation manual

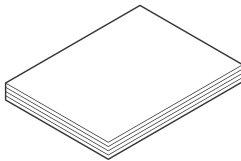

- Stainless Steel Diverter
- Adapter

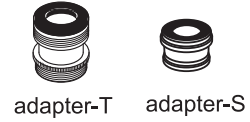

- Diverter with Shower
- Adapter

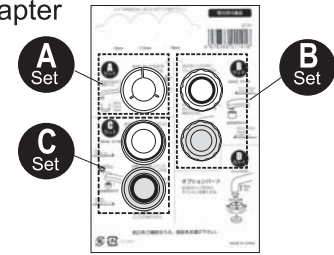
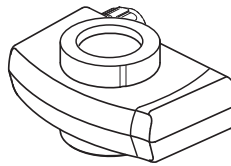

* The power cord provided differ according to the country in which the product is intended to be used.

About the usage

- pH test liquid set

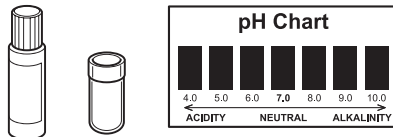

pH test liquid Test tube pH color chart

- pH test paper

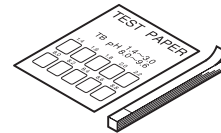

- Cleaning tank

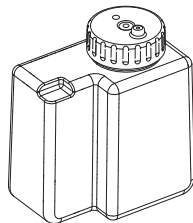

- Electrolysis enhancer



- Cleaning powder

30g×6pcs

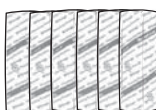

- Cleaning cartridge



- Secondary water hose

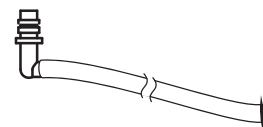

Name of each part

English

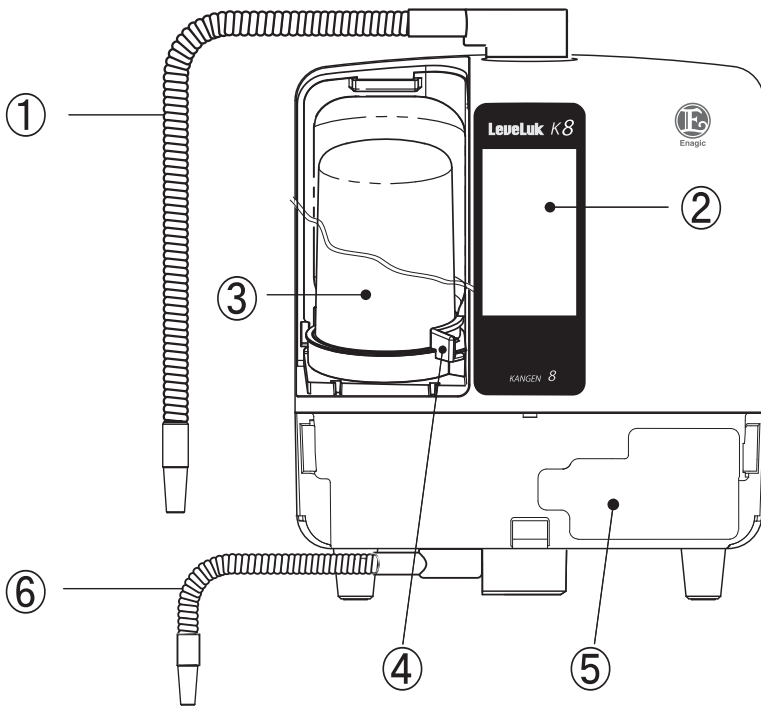

- ① Flexible pipe
- ② Touch display (Display and Operation)
- ③ Water filter (See page EN24)
- ④ Tray holder
- ⑤ Tank
 - The electrolysis enhancer tank (See page EN20)
 - Cleaning tank (See page EN27)
 - Mineral solution tank(optional) (See page EN22)
- ⑥ Secondary flexible pipe
- ⑦ Filter cover
- ⑧ Tank cover
- ⑨ Appliance Inlet
- ⑩ Adjuster<rear only>
- ⑪ Water supply hose

<Top face>

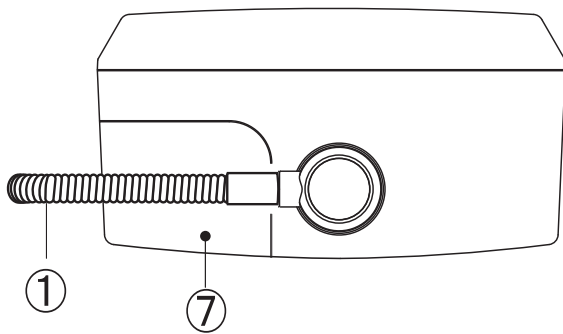

<Bottom face>

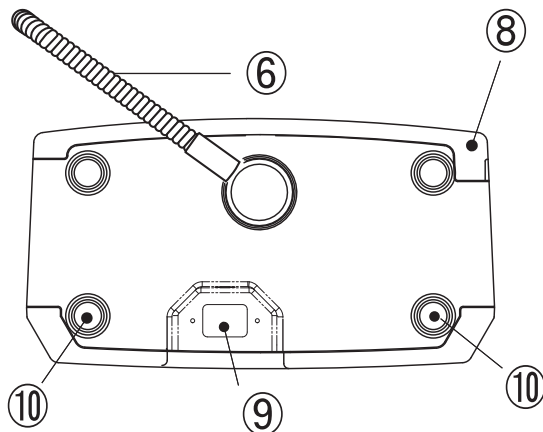

<Rear face>

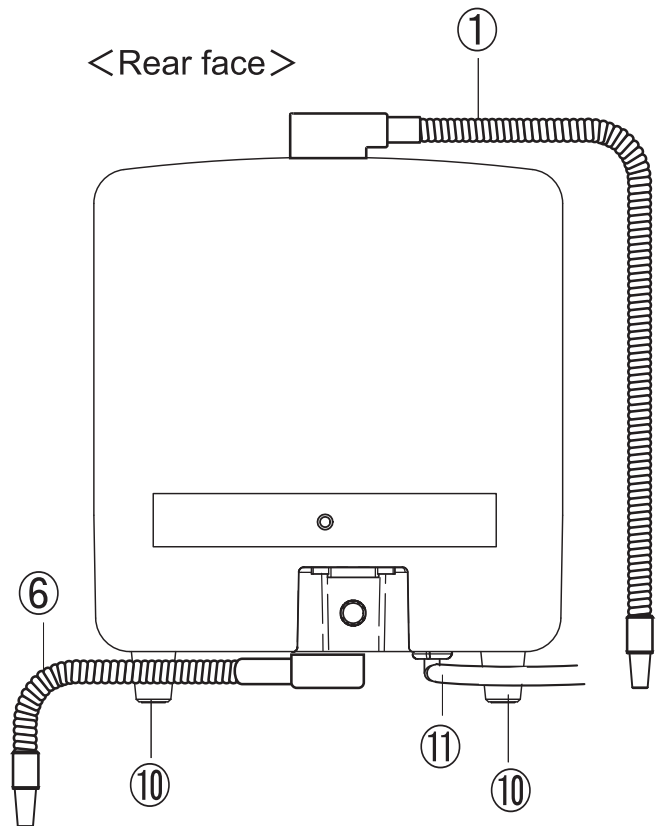

Touch display (Display and Operation)

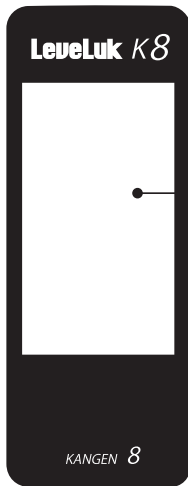

- **Home screen**
- **Setting screen**
- **Attention, Warning screen**
 See page EN29
- **Power Off screen**
 Canceling the OFF condition.(Power ON)
 See page EN17

Basic operation

Operate the touch display by touching it with your finger.

*Precautions for using the touch display.

The touch display is designed to be operated by gently touching it with the finger. Do not press it hard, or press it with a pointed object (your fingernail, or a ballpoint pen, pin, etc.).

The touch display may fail to operate when you touch it in the following ways. Also, note that such behavior may result in a malfunction.

- Operating the touch display while wearing gloves
- Operating the touch display with the tip of your fingernail
- Operating the touch display while a protective sheet or a seal is applied to it
- Operating the touch display while it is wet
- Operating the touch display while your finger is damp with perspiration or water

Home screen

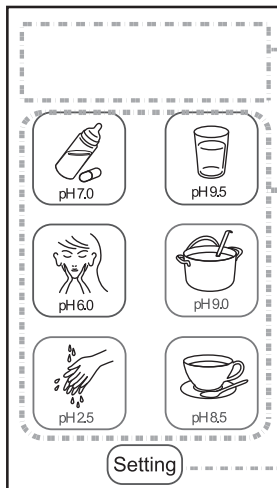

- ① **Display section**
 : Indicates the name of the selected processed water and also the operation when water is being passed through the unit.

- ② **Setting button**
 : Displays the setting screen (refer to the below)

③ Processed water button

- pH9.5** : KANGEN Water pH 9.5
- pH9.0** : KANGEN Water pH 9.0
- pH8.5** : KANGEN Water pH 8.5
- pH7.0** : Clean Water pH 7.0
- pH6.0** : Beauty Water pH 6.0
- pH2.5** : Strong Acidic Water pH 2.5

Setting screen

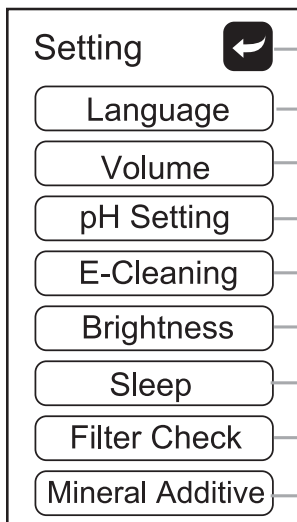

- ① **Language button**
 : Setting the language (See page EN16)

- ② **Volume button**
 : Setting the volume (See page EN16)

- ③ **pH Setting button**
 : Adjusting the pH (See page EN22)

- ④ **E-Cleaning button**
 : Cleaning inside the unit (See page EN27)

- ⑤ **Brightness button**
 : Setting the brightness of display (See page EN17)

- ⑥ **Sleep button**
 : Setting the time of power-off. (See page EN17)

- ⑦ **Filter Check button**
 : Confirming the filter usage status (See page EN16)

- ⑧ **Mineral Additive button**
 : Using the mineral tank(optional)

- ⑨ **Back button**
 : Go back to the previous screen

Installation

Selecting a location

⚠ Attention



Please observe

- Do not place anything on the machine. (Trouble or falling may result.)
- Do not plug the secondary pipe or hose opening. (Can cause water leak or electrolytic error.)
- Check the secondary pipe or hose to see if it is twisted or bent. (Can cause water leak or electrolytic error.)
- Keep the secondary pipe or hose level lower than the level of the machine. (Otherwise, the water in the machine will not drain properly.)
- Do not move or transport the machine with electrolysis enhancer fluid in the electrolysis enhancer tank. May cause damage due to leaking fluid.

Install this system in compliance with state and local regulations.

● Install in the following types of location

<p>● In a well ventilated area</p>	<ul style="list-style-type: none"> ● An area away from flammable objects. ● In an area with room temperature between 41 to 104°F / 5 to 40°C ● An area with relative humidity lower than 90% 	<p>● On a flat stable area capable of supporting the weight of the machine.</p>
<p>● An area not exposed to direct sunlight, wind or rain.</p>	<p>● An area free from splashing water, steam, chemicals and dust.</p>	

Installing the unit

Install on a kitchen counter.

*Note: Install on a flat place.

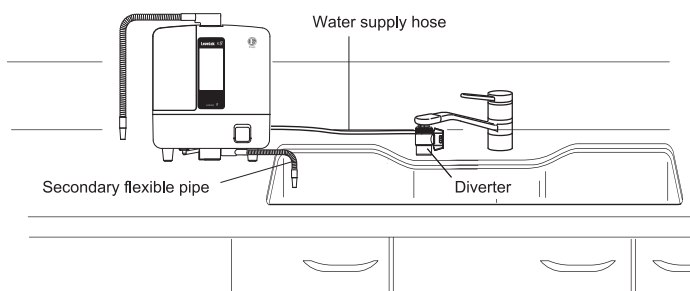

Installing the diverter (1)

The diverter may not be able to be installed on some types of faucets. Check the type of faucet beforehand. Then fit the diverter on the faucet in the specified manner.

Inner screw type

In the case of the Stainless Steel Diverter

Adaptor: T or S

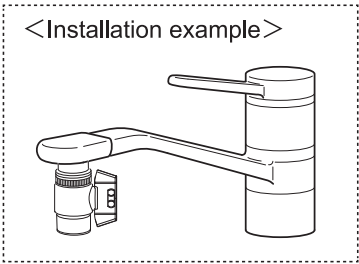
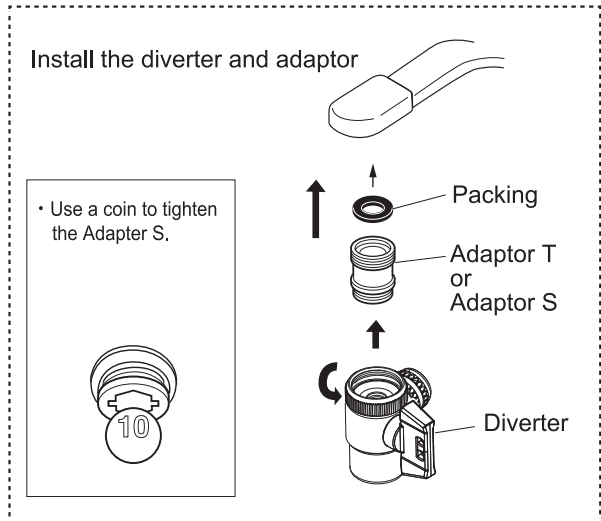
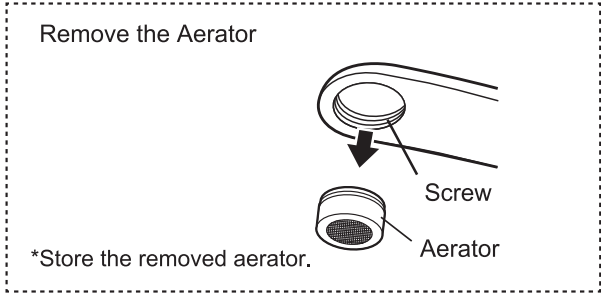

In the case of the Diverter with Shower

Adaptor: C set

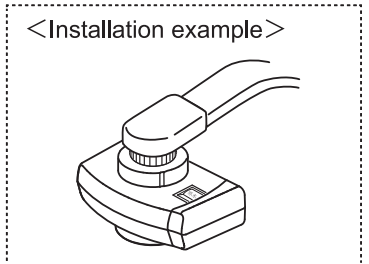
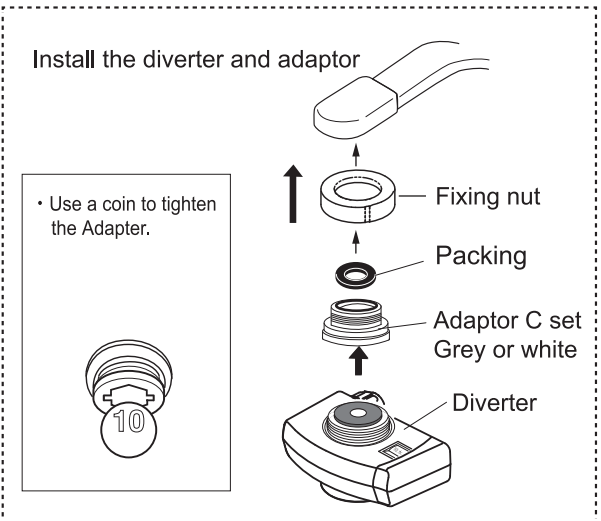
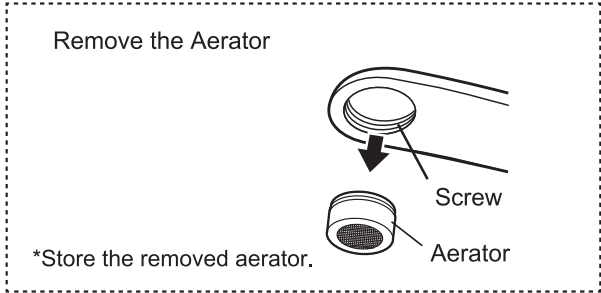

! If the thread diameter or thread pitch does not fit, the threads may get damaged. Make sure the thread diameter and pitch are as specified.

The faucets shown at right cannot accept the diverter.

With a sensor	Screw diameter does not match	Faucet whose nossible part is short.	Square faucets
	<ul style="list-style-type: none"> When the accompanying adapter does not fit. <p>φ0.88inch/φ22mm is OK</p>	<p>0.4inch/10mm or smaller 0.96inch/24mm or bigger</p>	

In this case, add a dedicated faucet or install the specific diverter. For details, contact your dealer.

English

Installing the diverter (2)

The diverter may not be able to be installed on some types of faucets. Check the type of faucet beforehand. Then fit the diverter on the faucet in the specified manner.

Outer screw type

Only the Diverter with Shower Adaptor: B set

Remove the Aerator

*Store the removed aerator.

Install the adapter and the diverter.

• Use a coin to tighten the Adapter.

< Installation example >

Faucet with expanded end

Only the Diverter with Shower Adaptor: A set

Measure the D dimension, and select one of three fixing rings (16, 17.5, 19 mm).

< Installation example >

! If the thread diameter or thread pitch does not fit, the threads may get damaged. Make sure the thread diameter and pitch are as specified.

The faucets shown at right cannot accept the diverter.

With a sensor	Screw diameter does not match	Faucet whose nozzle part is short.	Square faucets
	<p>● When the accompanying adapter does not fit.</p> <p>φ0.88inch/φ22mm is OK</p>	<p>0.4inch/10mm or smaller</p> <p>0.96inch/24mm or bigger</p>	

In this case, add a dedicated faucet or install the specific diverter. For details, contact your dealer.

Setting up the unit (Diverter : Stainless Steel Diverter)

Overall diagram

Insert the connector into the appliance inlet.

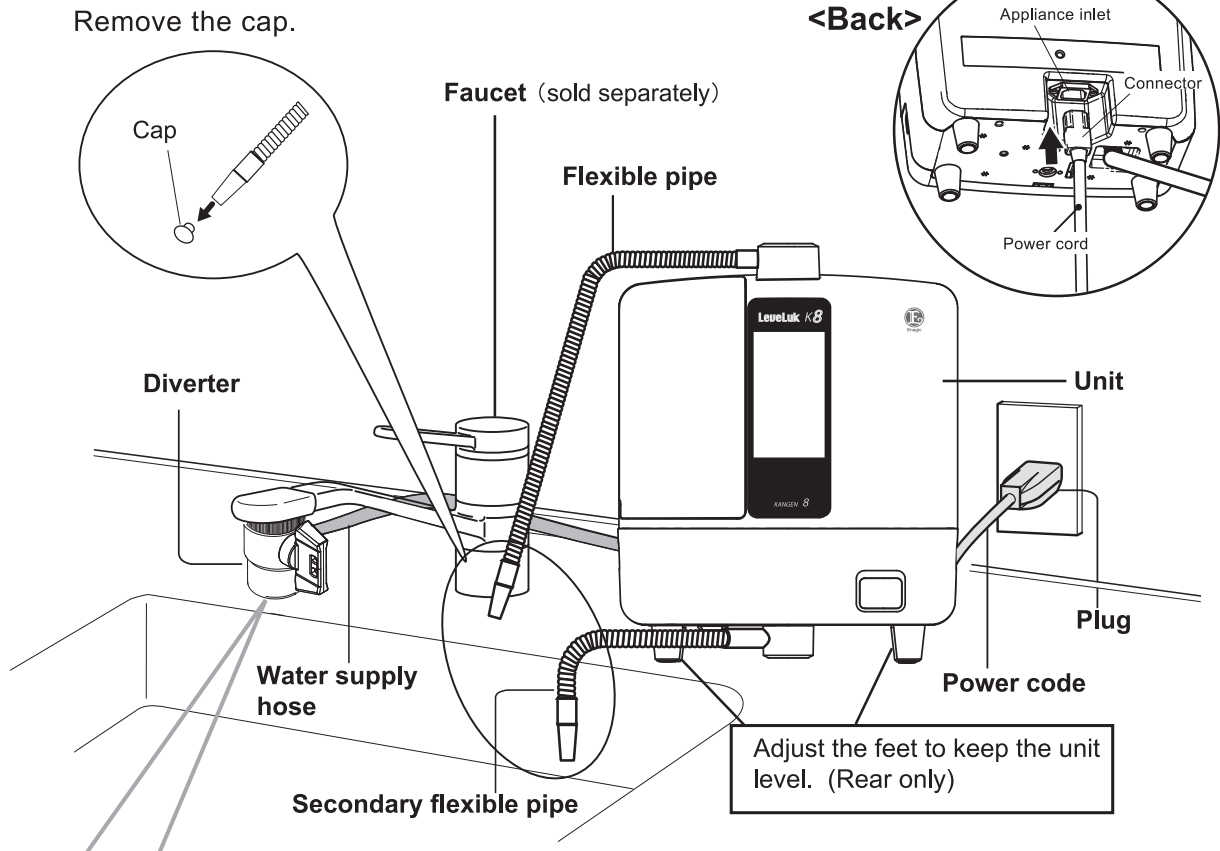

step 1 Remove the fixing nut.

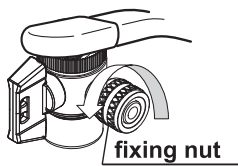

step 2 Fit the fixing nut over the hose, and then fit the hose onto the diverter.

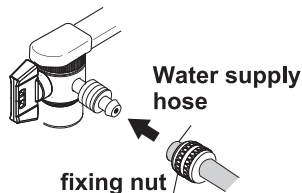

step 3 Insert the hose into the branch plug and secure it by tightening the fixing nut.

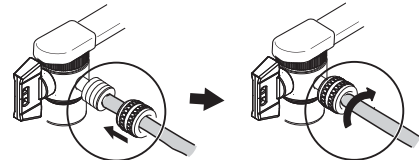

Lever

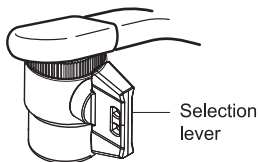

Processed water position	Tap water position
KANGEN Water, BEAUTY Water, STRONG KANGEN Water, or Clean Water flows from the flexible pipe.	Tap water

⚠ Do not use a tool to tighten the fixing nut because this may cause the nut to break.

Setting up the unit (Diverter : Diverter with Shower)

Overall diagram

Remove the cap.

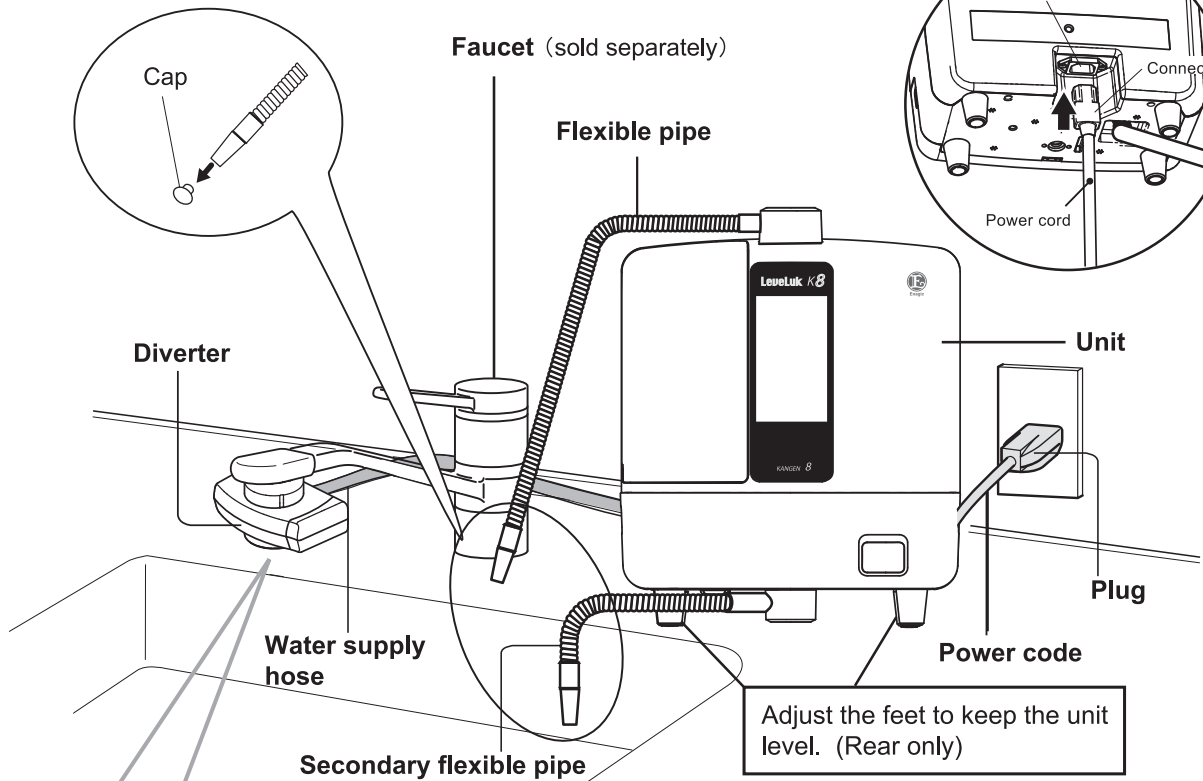

Insert the connector into the appliance inlet.

<Back>

English

step
1 Remove the fixing nut.

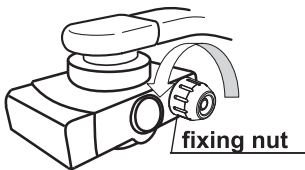

step
2 Fit the fixing nut over the hose, and then fit the hose onto the diverter.

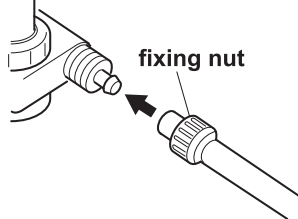

step
3 Insert the hose into the branch plug and secure it by tightening the fixing nut.

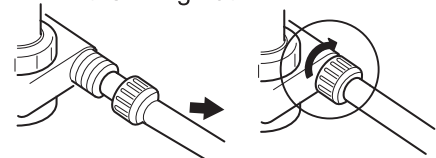

⚠ Do not use a tool to tighten the fixing nut because this may cause the nut to break.

Lever

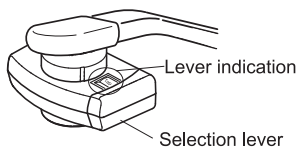

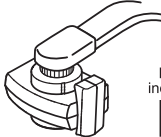
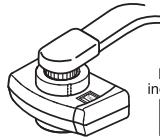
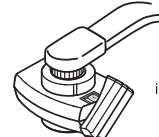
Processed water position	Tap water position	
KANGEN Water, BEAUTY Water, STRONG KANGEN Water, or Clean Water flows from the flexible pipe.	Tap water <Straight>	Tap water <Shower>
 Lever indication Ion	 Lever indication Tap	 Lever indication Shower

About the power cable



■ Please use the outlet of AC 100 - 240 V , 50 / 60 Hz for household use.

*Using improper voltage will void the warranty

Warning

 Prohibited	<ul style="list-style-type: none">● Never bend, pull, twist, or bundle the power cord. Do not lay heavy objects on top of the cord or clamp the cord: This may damage the cord, and cause electric shock that may lead to hazardous fire.● Do not use a damaged power cord or loosely fitted one. It may cause electric shock, short circuit or fire.● Stapling the power cord is strictly prohibited. This will cause irreparable damages to the cord and possibly fire.● Do not plug too many plugs into one outlet.● When cleaning the outlet, first disconnect the power plug. Dust on outlets can cause fire.● Connect or disconnect the power plug by holding the plug instead of the cord. Pulling the cord can cause breakage, fire, and/or electric shock.● Use only the proper power supply/voltage. Use improper power source/voltage can cause fire or electric shock.● If the power cord gets damaged, contact your local dealer for repairs.
---	---

Attention

 Please observe	<ul style="list-style-type: none">● Please be sure that the power cord can be easily unplugged prior to use.● Be sure to check that all buttons work properly.● Please bundle the cord during storage to avoid damage.
	<ul style="list-style-type: none">● A wet plug can cause electric shock. If the power plug is severely wet<ol style="list-style-type: none">(1) Disconnect the plug from the outlet(2) Wipe the water off the plugs(3) Consult your local dealer for repairs● Never handle power plugs with wet hands. If power plug is wet, first disconnect it completely from the outlet and wipe it dry. Failure to follow these procedures may result in electric shock.● Always unplug this product after use.

Setting menu

Setting the language

You can set the language.

step

1 Go to Settings >Language

: Select "Setting" in the home screen and touch "Language".

step

2 Touch the item on the screen corresponding to the desired language.

: A voice guidance message will be played in the set language.

step

3 Touch the back button

: Back to the setting screen.

<Language screen>



Default: English

Setting the volume

You can set the volume level of the voice guidance

step

1 Go to Settings >Volume

: Select "Setting" in the home screen and touch "Volume".

step

2 Touch the button (High Low Off) corresponding to the desired volume level.

: The selected volume level will be set.

Button	Meaning
High	Sets the volume level to high.
Low	Sets the volume level to low.
Off	Mutes the voice guidance.

* You cannot change the operation tone.

<Volume screen>

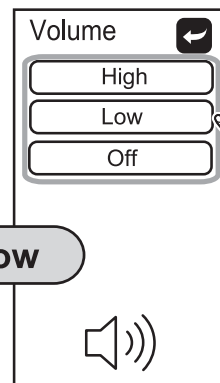

Default: Low

step

3 Touch the back button

: Back to the setting screen.

Check the filter

Indicates the usage of the current filter.

Use as a rough guide to the time remaining until the filter is to be replaced.

step

1 Go to Settings >Filter Check

: Select "Setting" in the home screen and touch "Filter Check".

A Indicates the total amount of water passed through the filter.
(Rough guide to the time remaining until the filter is to be replaced: Approx. 6000 L)
: 「」 One graduation mark is approx. 1000 L.

B Indicates the total time that the filter has been installed.
(Rough guide to the time remaining until filter replacement: Approx. 1 year)
: 「」 Approx. two months per graduation

As the amount of water used or the time during which the unit is used increases, the () bars change progressively to (). When () becomes red, it is time to replace the filter.

* A rough guide to the time remaining until the water filter is to be replaced is the value obtained from a test using standard water quality and water pressure (JIS S 3201 Testing Methods for Household Water Purifiers). When using general tap water, the replacement time may differ according to the water quality and the water pressure.

<Filter check screen>

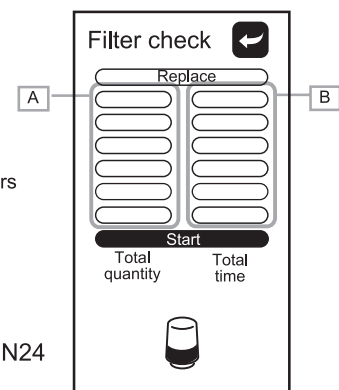

Replacing the water filter See page EN24

step

2 Tap the back button

: Back to the setting screen.

Setting the brightness

You can set the brightness of the screen.

step

1 Go to Settings >Brightness screen

: Select "Setting" in the home screen and touch "Brightness".

step

2 Touch the button (**Bright** **Natural** **Dark**) corresponding to the desired brightness.

: The selected screen brightness will be set.

step

3 Touch the back button 

: Back to the setting screen.

<Brightness screen>

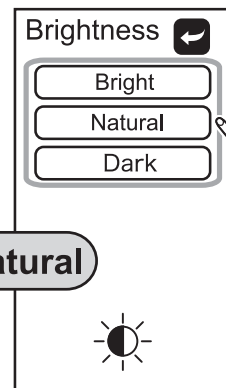

Setting the sleep

If you do not perform an operation for a certain fixed time, the screen and the power will turn OFF. You can set this fixed time as desired.

Screen example

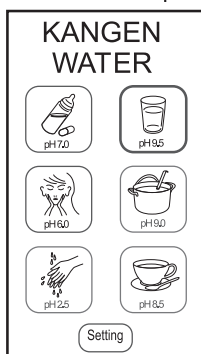

Lapse of time during which no operation was performed.

Default: 1 min

<Power OFF screen>



Touch the screen or run water through the unit.

Canceling the OFF condition (Power ON)

- Touch the screen
-The screen appears.
- Run through the unit
-The processed water that you selected before the unit switched OFF is discharged. (KANGEN WATER)

step

1 Go to the Settings >Sleep

: Select "Setting" in the home screen and touch "Sleep".

step

2 Touch the button (**1 min.** **2 min.** **3 min.** **4 min.** **5 min.**) corresponding to the desired time.

: The time the unit turns off automatically will be set

step

3 Touch the back button 

: Back to the setting screen.

<Sleep screen>

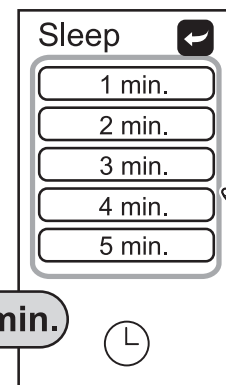

Producing KANGEN Water, Clean Water, Beauty Water

Use water that is at a temperature of less than 35°C. (Failure to observe this precaution may cause the water filter and the main body of the unit damage.)

step

1 Move the faucet lever to the processed water position.

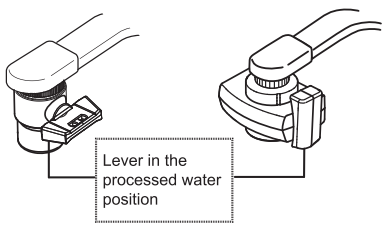

Warning
You cannot drink Beauty water.
 Check page EN6 concerning the use of processed water.

step

2 Touch the desired button on the Home screen.

*Power on : Touch screen or running water
 : The name of the processed water that you selecte action appears, and a voice is output. (See the figure below.)

step

3 Open the faucet to run water through the unit.

: Processed water will be discharged from the flexible pipe.
 : The indication of water running appears on the display, and a voice is output.(See the figure below.)
 *The pH value varies according to local water characteristics and water pressure.

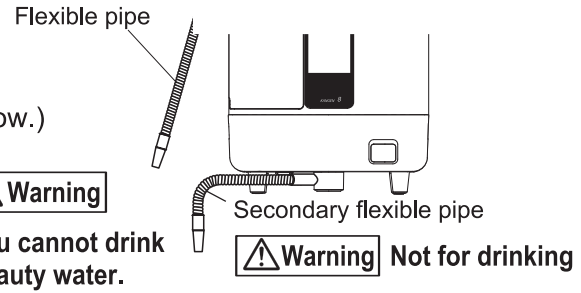

step

4 Turn off the faucet to stop production of water.

: If you wish to produce water continuously , follow step **3** of the operation procedure.

Screen display and voice guidance

Screen	Select button	pH level	After touching a selection button		When water is being run through the unit	
			Display section	Voice	Display section	Voice
		pH 9.5	KANGEN WATER	KANGEN WATER 9.5	KANGEN)))))))))	KANGEN WATER 9.5
		pH 9.0	KANGEN WATER	KANGEN WATER 9.0	KANGEN)))))))))	KANGEN WATER 9.0
		pH 8.5	KANGEN WATER	KANGEN WATER 8.5	KANGEN)))))))))	KANGEN WATER 8.5
		pH 7.0	CLEAN WATER	Clean water	CLEAN)))))))))	Clean water
		pH 6.0	BEAUTY WATER	Beauty water	BEAUTY)))))))))	Beauty water

How to measure pH value of KANGEN Water

• Measure the pH value of the KANGEN Water by using the pH test liquid at least once a month.

Optimum pH

Potable range ... pH8.5~9.5

About the pH test liquid

This test liquid is used to periodically measure the approximate value of the pH.
*The pH test liquid can not measure the pH below 4.0.

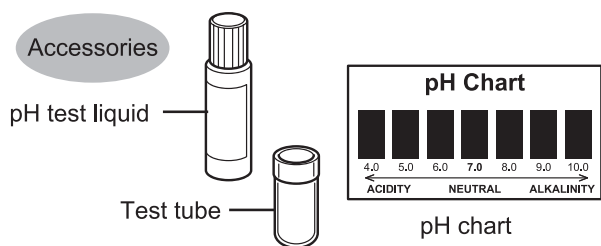

⚠ Attention

- Do not drink the water in the test tube after testing.
- Keep the testing liquid in a cold and dark place.
- Store the pH testing liquid set out of children's reach.

step

1 Put KANGEN Water in the included test tube about 0.8 in.(2cm) deep.

- The pH is unsteady in water initially processed. Therefore, flow the water for approximately 10 seconds before sampling.

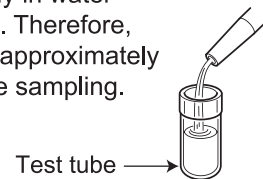

step

2 Add about 1~2 drops of test liquid in the tube and shake the content well.

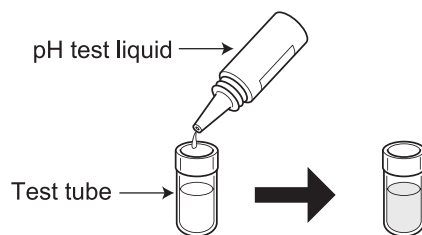

step

3 Compare the color of the water in the test tube with that of the color chart paper and check the pH concentration.

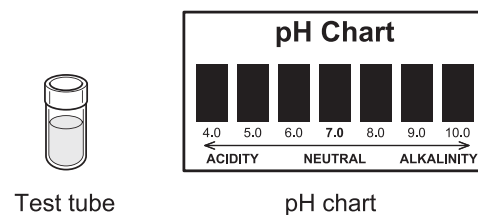

⚠ Attention

- When the water filter is new (approx. 1 week), the pH is sometimes slightly high.
- The pH value varies according to local water characteristics and water pressure.

Concerning the result of measuring the pH value

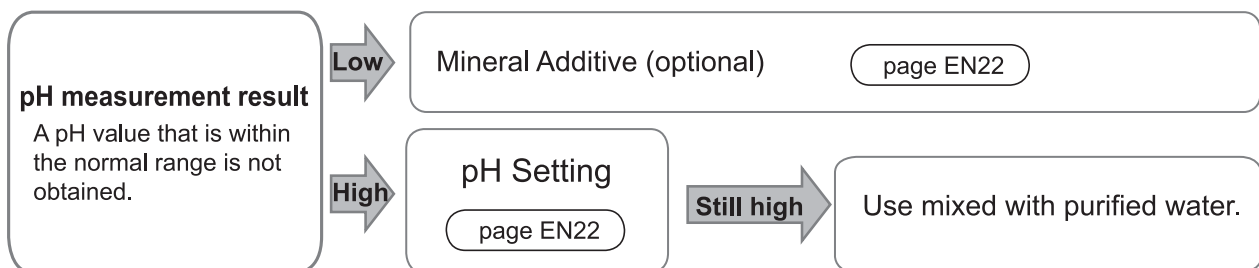

The value is lower than the normal range.	[Cause] ● The hardness of the tap water is low, and the water does not readily become alkaline. ● Well water or other water that contains a large amount of carbon dioxide gas. ● The electrolyzing performance of the unit has decreased. → E-cleaning (page EN27)
The value is higher than the normal range.	[Cause] ● The tap water is very hard, and readily becomes alkaline. ● The cartridge is new. → Continue to use as is. (Measure the pH again after one week.)

Producing Strong Acidic Water / Strong KANGEN Water

Use water that is at a temperature of less than 35°C. (Failure to observe this precaution may cause the water filter and the main body of the unit damage.)

step 1 Move the faucet lever to the processed water position.

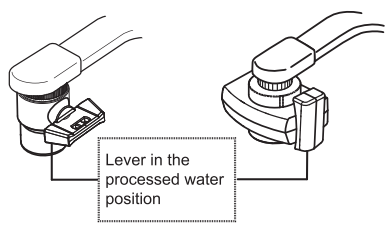

Warning
 You cannot drink Strong Acidic Water or Strong KANGEN Water.
 When you wish to use processed water, check page EN6.

step 2 Install the electrolysis enhancer tank.

- ① Remove the tank cover and remove the electrolysis enhancer tank. Remove the cap and place electrolysis enhancer into the tank. Replace the cap and tighten it.
- ② Install ① in the tank mounting position.

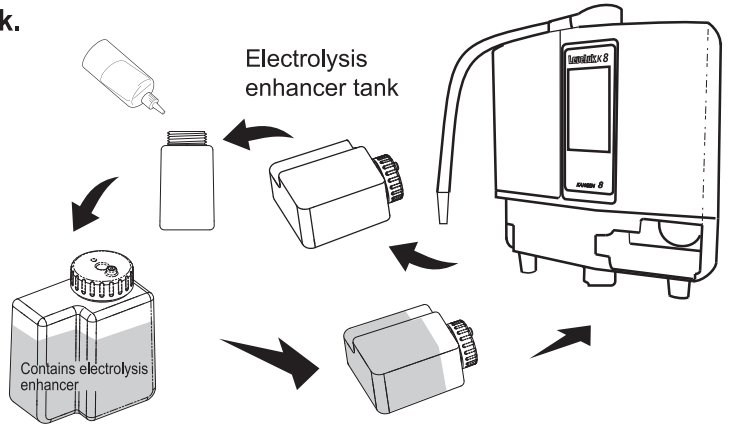

step 3 Touch the select button  on the Home screen.

*Power on : Touch screen or running water

Display section	 Voice
STRONG ACIDIC WATER	Strong acidic Water

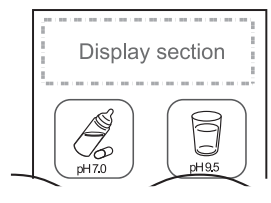

step 4 Open the faucet to run water through the unit.

: Strong KANGEN Water is discharged from the flexible pipe.
 Strong Acidic Water is discharged from the secondary flexible pipe.

Display section	 Voice
STRONG >>>>>>>>>	Strong acidic Water

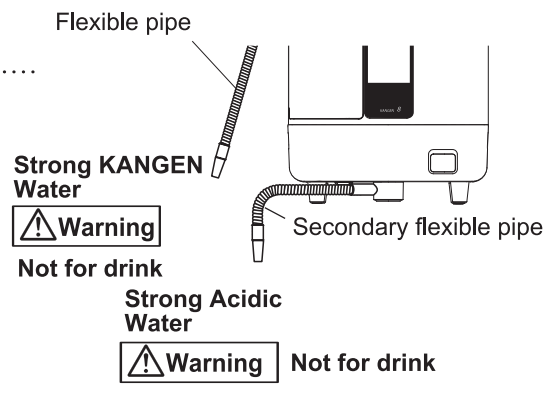

* The pH value varies according to local water characteristics and water pressure.

step 5 Turn off the faucet to stop production of water.

- : If you wish to produce water continuously, follow step 3 of the operation procedure.
- : Select another mode and continue to run water until the cleaning mode stops.

 See page EN23

How to measure pH value of Strong Acidic Water

- The pH test liquid can not measure the pH below. For measuring the pH value of Strong Acidic Water, use the pH test paper.

step
1 Pour strong acidic water from the secondary flexible pipe into a cup.

*The pH is unsteady in water initially processed. Therefore, flow the water for approximately 10 seconds before sampling.

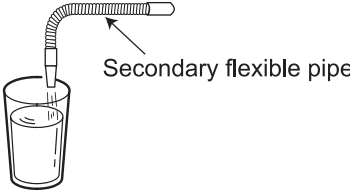

Secondary flexible pipe

step
2 Carefully dip the pH test paper in the water sample (less than half a second). Shake the pH test paper gently to remove excess water.

*Dipping the test paper too long (longer than 1 second) causes the pigment to be dissolved into the sample water resulting in inaccurate test results.

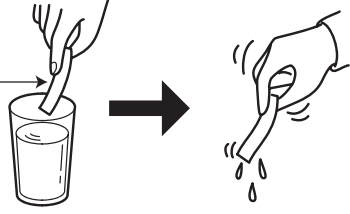

pH test paper (Accessories)

step
3 Check the color of the wet portion of the paper to the color chart in a brightly well lit place. (less than 5 seconds.)

*The consequence of leaving the pH test paper exposed to air for a long period of time may lead to inaccurate results.

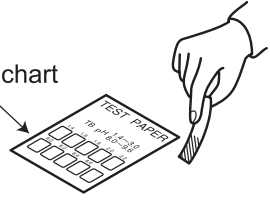

Color chart

⚠ Attention

- The pH test paper can only be used to check the pH value of Strong Acidic Water.
- Do not lick the pH paper. If you do, rinse out your mouth and gargle immediately.
- The pH test paper must be kept in cool, dry, and dark places.
- Store the testing liquid and paper out of reach of children.

Result of pH measurement

Result of pH measurement

The pH value does not fall below 2.7.

➔

- There is too fast of water flow.
 - ➔ Turn the faucet so as to reduce the flow of water.
- The electrolysis enhancer tank is empty.
 - ➔ Replace the electrolysis enhancer tank with a full one.

pH setting

- If the pH value becomes higher than the value in “Guide to pH,” you can adjust the strength of the current and finely adjust the pH value.



step

1 Go to the Setting >pH setting

: Select “Setting” in the home screen and touch “pH setting” .

step

2 Touch [+] or [-] to adjust the strength of the current.

Button	Description
	Increases the current. The pH value rises.
	Decreases the current. The pH value falls.

Default: 7

< pH setting screen >

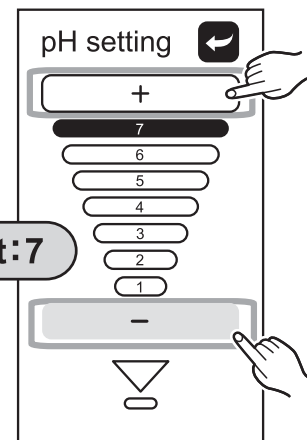

step

3 Touch the back button

: Back to the setting screen.

Mineral Additive (Optional)

Potable range : pH8.5 ~ 9.5

- If the pH value remains lower than the normal range, add calcium lactate (must be purchased separately). If the pH value is within the normal range, there is no need to add calcium lactate.

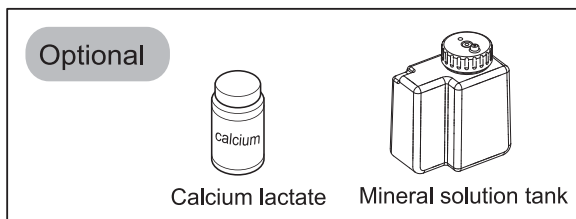

step

1 Place 20g of calcium lactate in the mineral solution tank and add 400ml of water, then close the cap and shake well.

step

2 Install the mineral solution tank of step 1 at the position of the tank at bottom right of the main body of the unit.

step

3 Go to the Setting >Mineral Additive

: Select “Setting” in the home screen and touch “Mineral Additive” .

step

4 Touch **Yes** , then touch the button until the Home screen appears.

step

5 Select the desired KANGEN water.

< Mineral Additive screen >

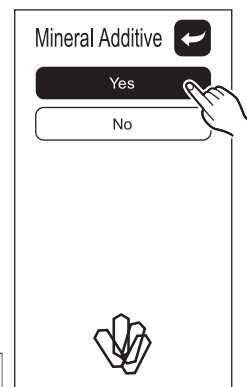

Attention

- Calcium lactate (optional) increases the calcium concentration in the KANGEN Water.
- After use, wash the inside of the mineral solution tank so that no calcium lactate liquid remains, then carefully wipe away moisture, and allow the tank to dry.

About the auto cleaning

Calcium deposited on the electrodes in the electrolysis tank may result in degraded water. This unit automatically cleans the tank.

KANGEN Refresh

When KANGEN water or Beauty water has been used for more than 10 minutes.

When the faucet is closed

KANGEN refresh takes place (approx. 10 seconds).

Attention Do not use the water that comes out from the pipe or hose.

<Screen display>

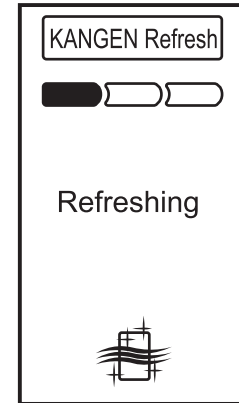

Cleaning

- When another processed water mode is to be selected after making Strong Acidic water.
- When the unit has not been used for more than 24 hours.

* When cleaning is to be carried out at the commencement of the next processed water operation, a "Cleaning Notification" indication will appear.

Attention

- While the unit is producing the kinds of water listed above, the unit will not switch over to the automatic cleaning mode. The unit will automatically clean the next time the unit is productive.

When water is run through the unit

Carrying out cleaning (approx. 30 seconds)

While continuing to run water through the unit, wait until cleaning is completed.

Attention Do not use the water that comes out from the pipe or hose.

Voice "Starting the cleaning cycle."

"The cleaning cycle is finished."

<Screen display>

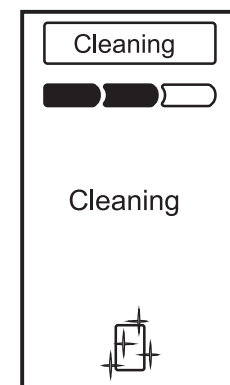
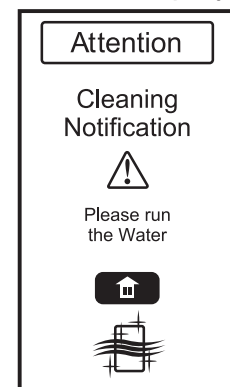

Replacing the water filter

The water filter is a standard accessory that comes with a new unit.
(Replacement activated charcoal water filters are available. Contact your local dealer.)

Guide to replacing the water filter

Total amount of water run through the filter: 6,000 liters (a)

Period of use:
Approximately 1 year

The flow volume of each kind of processed water is extremely small (clogged).

(a) Value indicated in JIS S 3201 Testing Methods for Household Water Purifiers.

⚠ Attention Rough guide to the period of use

•When using general tap water, the replacement time may differ according to the water quality and the water pressure.

Filter check



See page EN16 ■ You can check the condition of use of the cleaning filter by observing the screen. Use the screen indication to help you prepare a new filter.

Notification that it is time to replace the water filter

When either the total amount of water run through the unit or the time during which the unit has been used reaches the approximate value at which the filter must be replaced, you will be notified by a screen display and voice guidance.

🔊 Voice

「It's time to replace the filter」

⚠ Attention

- The message does not appear while water is running.
- No notification instructing you to replace the filter due to clogging is output.

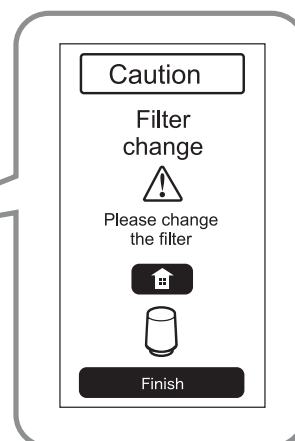
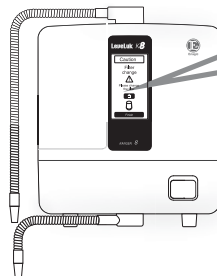

*Replace the filter if the water smells or has a strange taste, even if notification instructing you to replace the filter is not output.

button	subject
	Back to the Home screen. (Only 5 seconds)

When the “Replace filter” indication appears

Replace the water filter with a new one.

→ To the next page

When you cannot replace the filter immediately,

→ Operate in the same procedure as page EN26 “When using non-specified filter”.

*If filter replacement has not been completed, the “Replace filter” indication will re-appear after about 2 weeks.

If you continue to use a filter that has exceeded its target replacement time, the unit is liable to malfunction, so replace the filter as soon as replacement becomes necessary.

How to replace the water filter

⚠ Attention

- Do not pull out the power plug or connectors.
- Do not push over the unit or aim the flexible pipe upward.
- Replace the water filter after stopping the water.

step

1 Remove the filter cover.

While pushing the arrow mark () on the side of the unit, slide the cover upward and remove it.

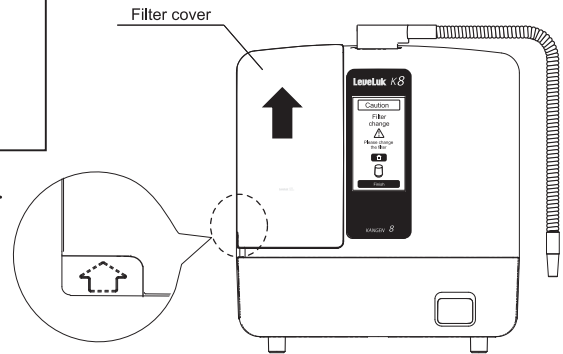

step

2 Remove the water filter.

Slide the holder knob to the left and release the holder, then pull up the filter and remove it.

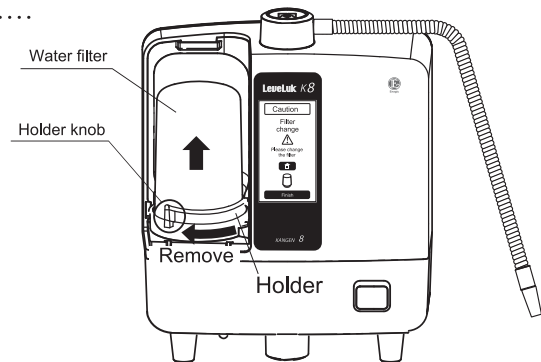

⚠ Attention

Be careful of water leaking out of the filter when removing the filter.

step

3 Install a replacement filter.

Check to ensure that the old O rings do not remain on the filter tray, and then push in the replacement filter while being careful of the installation position.

Install the holder, then slide the holder knob to the right and lock it in place.

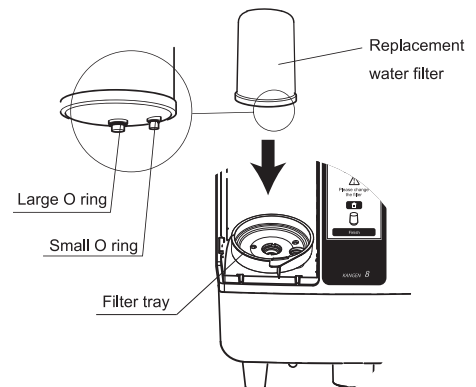

⚠ Attention

- Check to see if the two O rings have been fitted onto the water filter.
- Check to see if the holder is securely in place.

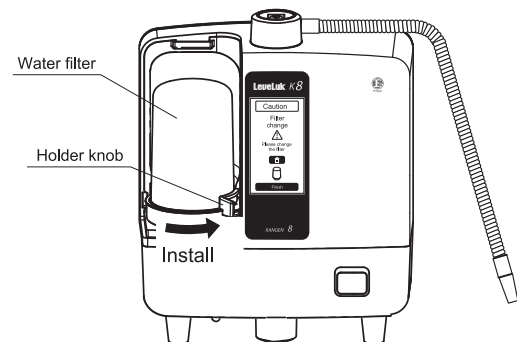

Continued on the next page.

How to replace the water filter

step

4 Replace the water filter cover.

Fit the three tabs at the bottom, then slide the cover downward and engage the tabs with the tabs at the top.

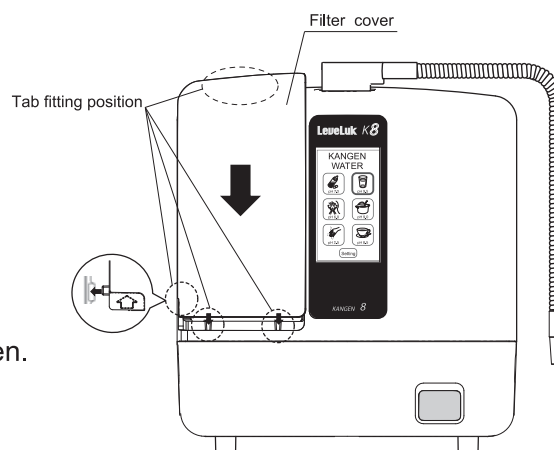

When using our specified filter

The filter history is reset automatically and the screen display reverts to the main screen.

"The filter has been set"

When using non-specified filter

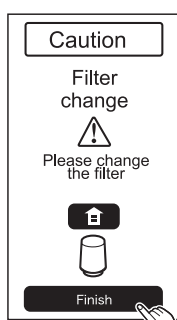

Touch the Finish button

In the following case, the unit will be unable to recognize the filter.

- ① The installed filter is not a genuine filter.
- ② The installed filter has exceeded its target replacement time.

button	subject
	Back to the Home screen. (Only 5 seconds)

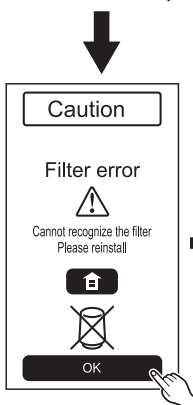

Touch the OK button

Back to the Home screen.

Attention

If the filter was replaced with a non-genuine one, the amount of water passed through it will fail to be correctly recognized, and after about 2 weeks the message "Filter change" will be displayed. Use of a non-genuine filter may cause the unit to break down. In such case the warranty will be rendered invalid.

Attention





- Run water through the machine for 3 minutes when you first use a new filter.
- Please ensure that the spent water filter (combustibles) observe the regulations of the region. (The material of water filter case is ABS resin. Please refer to page EN35 standard specifications for inside filtering material.)

E-Cleaning

Remove calcium adhering to the inside of the unit.

⚠ Attention

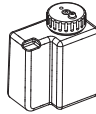
Items to be obtained

water:400ml	Cleaning powder	Cleaning tank	cleaning cartridge	Cap (red: 1 pc)
				

- Use two packets of our cleaning powder for one cleaning operation. The use of another manufacturer's powder may cause damage to the unit.
- If the cleaning solution gets into your eyes, wash it away immediately.
- Please use the cleaning powder once every week or two weeks.

The cleaning powder contains citric acid, which is commonly used as food additive and is harmless.

! Be sure to shut off the faucet and turn off the unit before cleaning.

Go to Settings >E-Cleaning

: Select "Setting" in the home screen and touch "E-Cleaning".

Necessary time for cleaning: Approx. 3 hours

: The cleaning procedure will be displayed on the screen. Carry out cleaning according to this procedure.

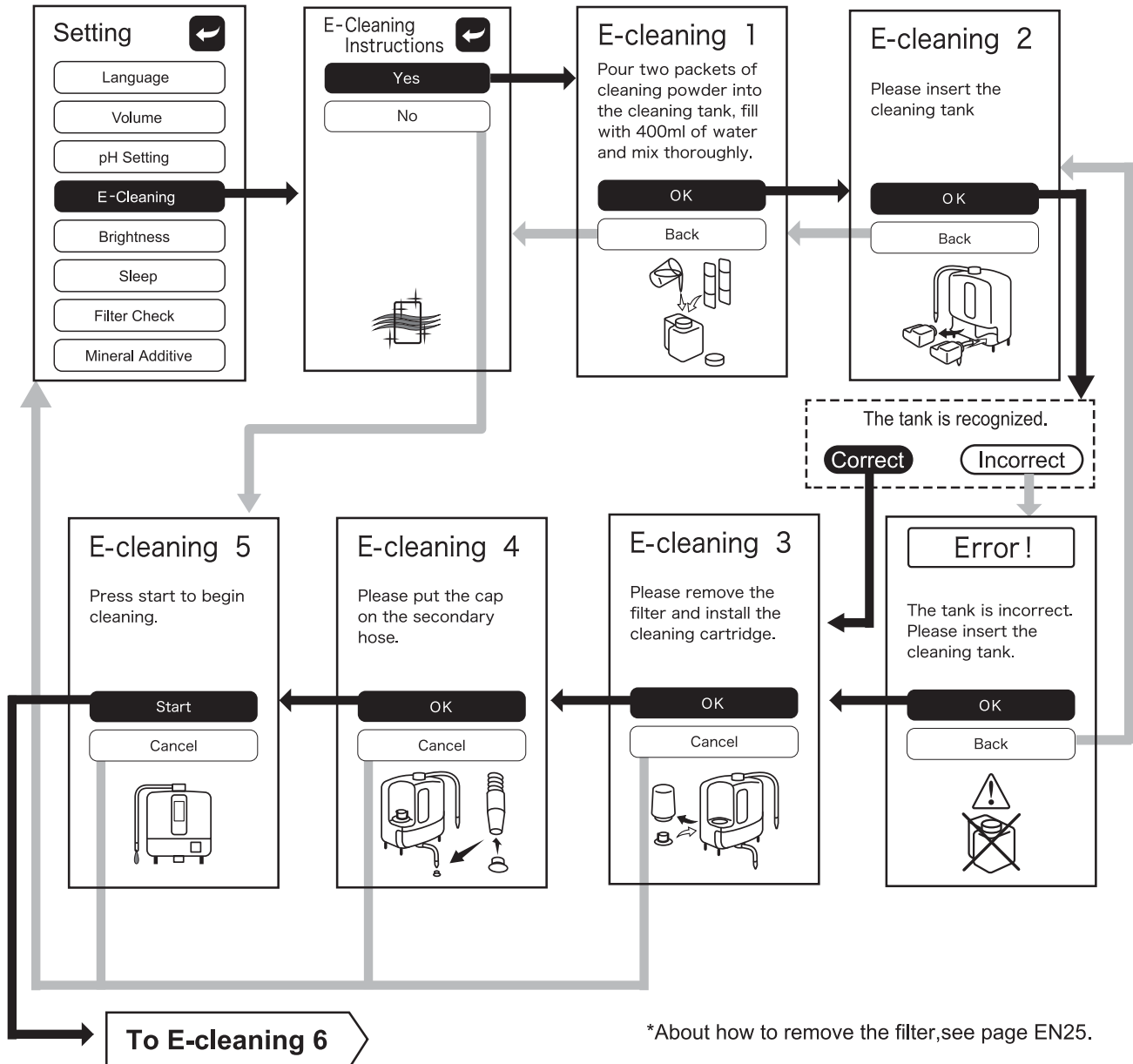

*About how to remove the filter, see page EN25.

E-Cleaning

English

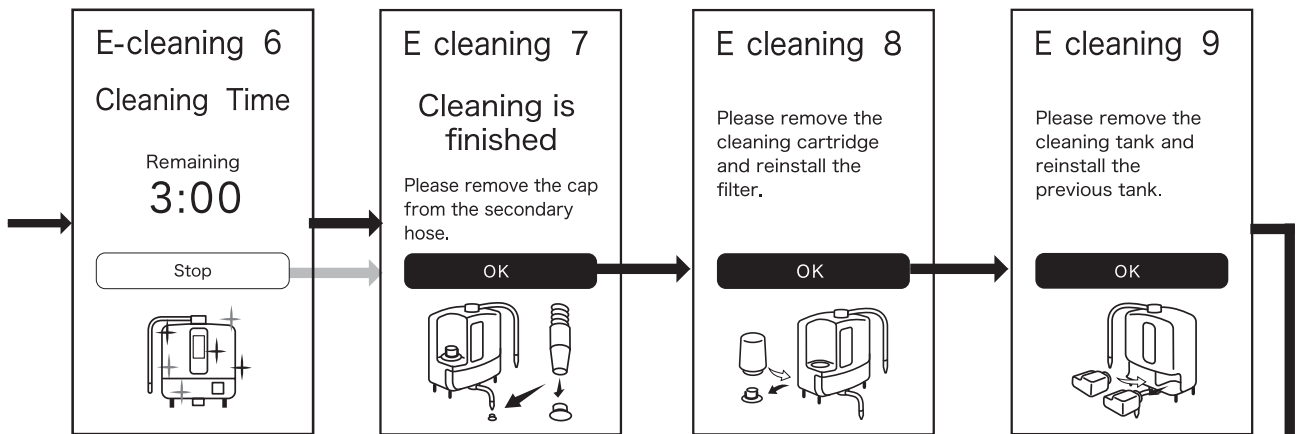

Attention

The water that flows out of pipe or hose is cleaning water, so do not use it.

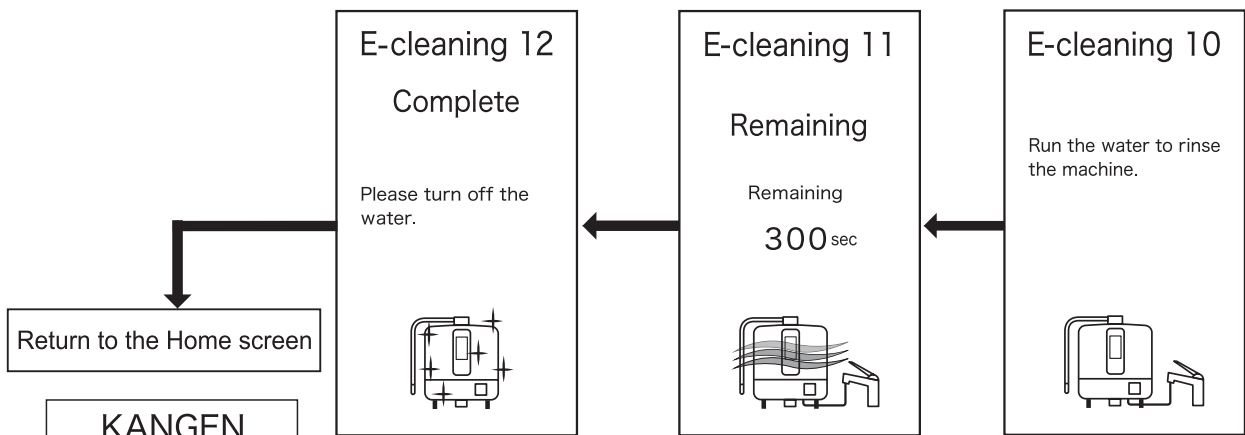

KANGEN WATER

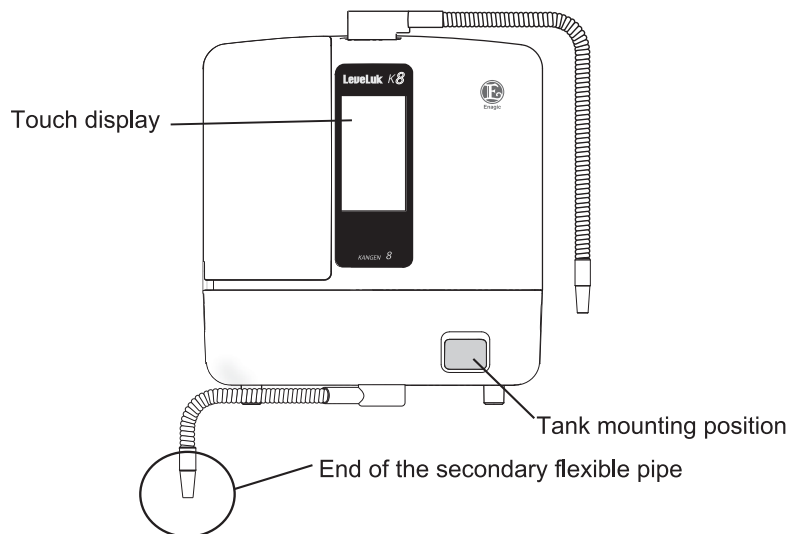

pH 7.0	pH 9.5
pH 6.0	pH 9.0
pH 2.5	pH 8.5

Setting

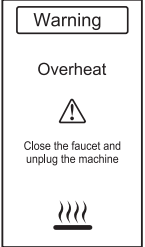
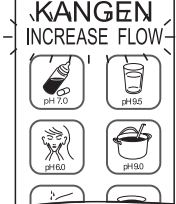
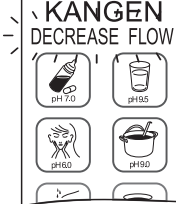

When this display appears

If any of the following messages is displayed on the screen, carry out the corresponding action.
If the message remains displayed despite corrective action being taken, unplug the unit and contact the distributor from whom you purchased the unit.

Screen display	Cause and necessary action	
 <p>Warning Hot Water Please run the cold water</p>	<p>This message is displayed if hot water at a temperature of at least 40°C is run through the unit and the hot water protection device operates.</p> <p>Voice “Hot water warning”</p>	<p>Immediately stop running hot water through the unit, and run water through it at a temperature of no more than 35°C. This message disappears when the temperature inside the main body of the unit falls.</p>
 <p>Warning Overheat Close the faucet and unplug the machine</p>	<p>This message is displayed when the temperature inside the unit rises and the temperature detection device operates.</p> <p>Voice “Overheat warning”</p>	<p>Close the faucet and switch it off. Then wait for more than 30 minutes or longer depending on the environment.</p>
 <p>KANGEN INCREASE FLOW</p>	<p>This message is displayed when the flow of the water is too slow.</p> <p>Voice “Increase flow”</p>	<p>Increase the water flow.</p>
 <p>KANGEN DECREASE FLOW</p>	<p>This message is displayed when the flow of the water is too fast.</p> <p>Voice “Decrease flow”</p>	<p>Decrease the water flow.</p>
 <p>Attention Cleaning Notification Please run the Water</p>	<p>This message is displayed when cleaning is to be carried out at the beginning of the next water processing operation.</p>	<p>Run the water until the notification disappears (about 30 seconds).</p> <p>Home Back to the home screen. See page EN23</p>

Continued on the next page.

Screen display

Cause and necessary action

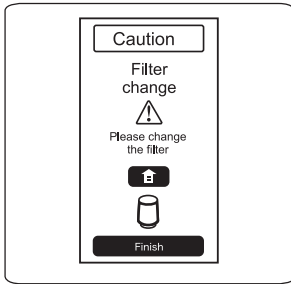

When water filter needs to be replaced.



“It's time to replace the filter”

Please replace the water filter.

Back to the home screen.

See page EN24

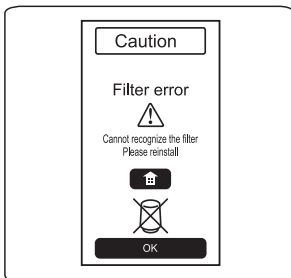

This message is displayed when a non-specified filter is installed.

This sometimes causes a reduction of function. Use our specified filter.

Back to the home screen.

See page EN26

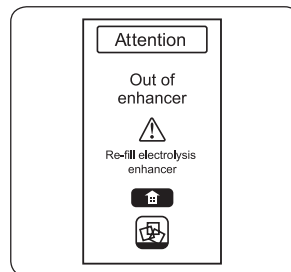

This message is displayed when the electrolysis enhancer is used up while strong acidic water is being made, or when there is no electrolysis enhancer in the tank.



“Re-fill electrolysis enhancer”

Close the faucet and add electrolysis enhancer before use.

Back to the home screen.



This message is displayed when **the electrolysis enhancer tank** is not installed.



“Please install the electrolysis enhancer tank”

Close the faucet and install the electrolysis enhancer before use.

Back to the home screen.

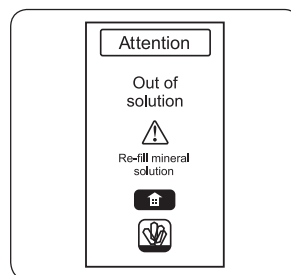

This message is displayed when the mineral solution is used up while “Mineral Additive” mode is activated, or when there is no mineral solution in the tank.

Close the faucet and replenish the mineral liquid before use.

Back to the home screen.

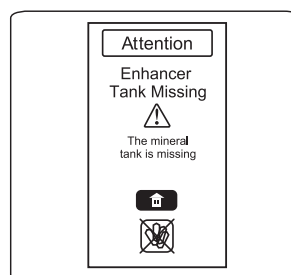

This message is displayed when **the mineral solution tank** is not installed.



“Please install the mineral solution tank”

Close the faucet and install the mineral solution tank before use.

Back to the home screen.

Troubleshooting

Trouble	Cause	Remedy
Nothing is displayed.	The power cord is not connected to the power outlet or the unit.	Check the connection.
The screen suddenly disappears.	Sleep function	See page EN17.
Water does not flow in cold weather.	The inside the unit is frozen.	Raise the room temperature and wait unit it melts.
Output of all types of water is getting low.	Water flow (pressure) is low.	Open the faucet wider.
	Water filter has clogged.	Replace the water filter with a new one.
	Cleaning timing.	Carry out powder cleaning.
KANGEN Water has chlorine odor.	The performance of the water purification filter is reduced.	Replace the water filter with a new one.
Whitish material is floating or has settled in KANGEN Water.	Calcium processed by electrolysis.	Harmless
	Cleaning timing.	Carry out powder cleaning.
The inside of secondary water pipe is stained dark.	Oxidizing material , such as iron has adhered.	Harmless
Dropping pH value when processing KANGEN Water and Beauty Water.	Calcium buildup in the ionizing cell.	 Touch the Beauty button and run water for about 1 minute to clean the ionizing cell.
	Cleaning timing.	Carry out powder cleaning.

Safety Precautions

To avoid injury or accident, please adhere to the following rules.

Warning



Prohibited

- People who have the following conditions should get doctor's or pharmacist's approval before drinking KANGEN Water generated with this water processor.
 - Please take the following precautions prior to drinking KANGEN Water.
 - Do not take medication with KANGEN Water.
 - If you are experience any discomfort in your health condition, please consult your physician or pharmacist.
 - If you are under a physician care, or are experiencing physician care, or are experiencing physical abnormality, please consult your physician or pharmacist before using.
 - Use only municipally treated water approved for drinking such as tap water.
 - The unit's chlorine removal ratio and pH value may vary according to the water quality of different localities.

- Please supervise children and senior citizens while they use the machine.
- This appliance can be used by children age from 8 years and above and persons with reduced physical, Sensory or mental capabilities or lack of experience and knowledge if they have been given supervision or instruction concerning use of the appliance in a safe way and understand the hazards involved. Children shall not play with the appliance. Cleaning and user maintenance shall not be made by children without supervision.

Failure to comply with all of the following warnings may cause electric shock, fire or accidents and can result in severe personal injury and or damage to property.

- Do not splash water or oil on the body.
- Never run the unit with a damaged power supply cord.
- Do not tamper with or attempt to repair the unit.

Attention



Please observe

- Avoid direct sunlight.

- May cause the unit to bend or warp.-

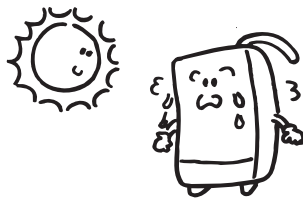

- Do not place the unit near hot objects or in the presence of corrosive gas.

- May damage or cause the unit to bend or warp.-

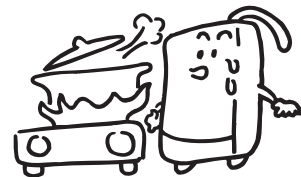

- Never place anything on the unit.

- It may cause damage or fall.-

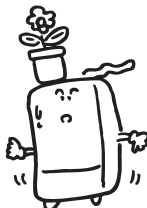

- Do not use thinner, benzene, cleansers or chlorine-based detergents for cleaning.

- May damage the unit. -

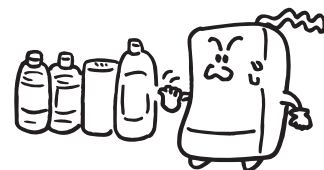

⚠ Attention

- **Never run hot (40°C or higher) into the unit.**
- It may damage or cause malfunctions.-

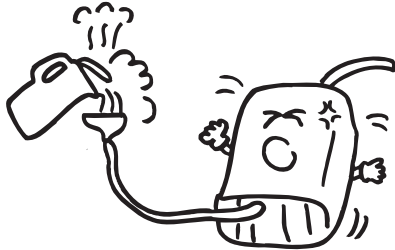

- **Do not use salt water or excessively hard water.**
- The unit may be damaged, or its service life will be shortened.-

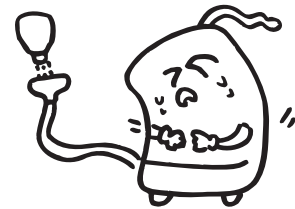

- **Do not use the unit when the secondary water hose is in an elevated position.**
- Water cannot flow out of the unit and therefore it may cause damage.-

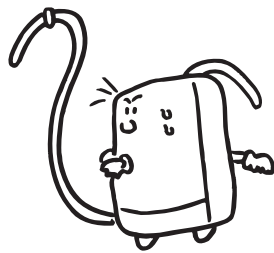

- **If you want to move the unit, first remove the electrolysis enhancer tank.**
- Leaking from the electrolysis enhancer may cause trouble.-

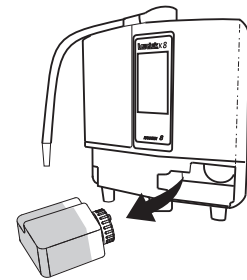

Please observe

- **Do not use processed water in aquariums or give to pets.**
- The unit may be damaged, or its service life will be shortened.-

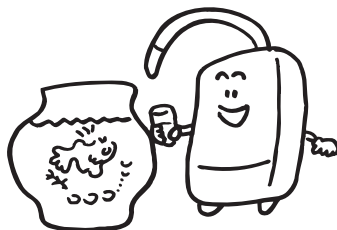

- **When using the unit in a area with cold temperatures please avoid running freezing water into the unit (When you are not using the unit for a long period of time, remove the water filter and keep it separately from the unit. At the time, do not touch the reset switch).**

- Failure to do so can result in damage or malfunction-



Options

① Flexible pipe
32in./800mm long

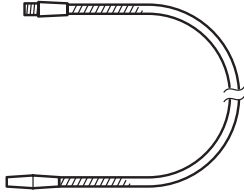

② Water supply hose
(40 ~ 200in./1 ~ 5m)

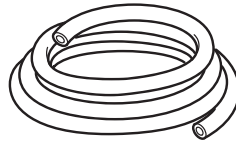

③ Secondary water hose
(40 ~ 200in./1 ~ 5m)

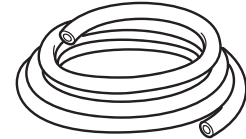

⑤ Mineral solution tank set
· Mineral solution tank
· Calcium lactate 20 g

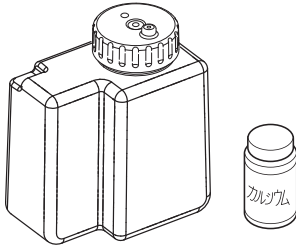

⑥ Electrolysis enhancer



⑦ Cleaning tank set
· Cleaning tank
· Cleaning powder (6 pcs.)

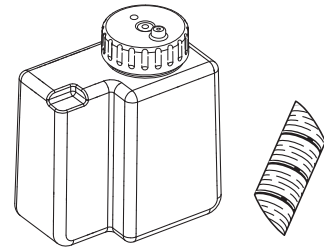

⑧ Water filter for replacement
Activated charcoal type
F-8

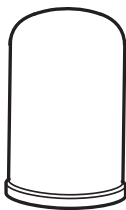

⑨ Cleaning powder
(24 pcs.)



Standard specifications

Item name		Leveluk KANGEN8		
Feed water specs and connection		One way diverter		
Power supply Rated current		100 - 240V AC 50 / 60Hz 2.6 - 1.1 A		
Power consumption		Approx.230W (If production is done at a hight KANGEN pH level)		
Main unit	dimensions	Approx. H 13.6 × W 11.0 × D 5.8 (inch) / H 34.5 × W 28.0 × D 14.7 (cm)		
	weight	11 lbs / 5 kg		
Ionizing system		Continuous ionizing system (Built-in flow rate sensor)		
Electrolysis	KANGEN Water	0.92 gal. /min. (3.5 L / min.)		
	Feed water pressure Approx.	14.3 psi / 100 kPa		
	Strong Acidic Water	0.34 gal. /min. (1.3 L / min.)		
	Feed water pressure Approx.	14.3 psi / 100 kPa		
	Electrolysis capacity settings	7 level	KANGEN Water at 3 levels (Approx.pH8.5/pH9.0/pH9.5) Clean Water (Approx.pH7.0) Beauty Water (Approx.pH6.0) Strong Acidic Water (Approx.pH2.5) Strong KANGEN Water (Approx.pH11.0)	
	Cleaning system of ionizing cell	· When KANGEN water or Beauty water has been used for more than 10 minutes (10 seconds when the water is stopped) · When water is not passed through the unit for 24 hours (30 seconds)		
	Materials of electrode and ionizing cell	Platinum-plated titanium		
Water filter	Filter material	Granulated antibacterial activated charcoal,calcium sulfite		
	Removable substance	Aesthetic Chlorine,Taste and Odor up to 1500 gallons		
	Un-removable substance	Metal ions/salt dissolved in original tap water		
	Replacement interval	When water is passed through the unit for about one year, or 6,000 liters have been passed through it (Varies according to region and water quality)		
Applicable water pressure		50kpa ~ 500kpa (Approx.0.5 kgf/cm ² ~ 5 kgf/cm ²)		
Available water temperature		41 ~ 95 °F / 5 ~ 35 °C		
Electrolysis enhancer (for Strong Acidic Water production)		Forced dissolving adding type		
Electrolysis enhancer (sodium choride)re-fill need indication		Voice guidance , LCD message		
Protective device		Current fuse 250V - 6A Heat Protect		
Detective device		Detection of temperature rise and hot water		

- Specifications and design subject to change for product improvements without notice.
- The electrolytic processing capacity and the filter service life largely depend on the water quality or how the machine was used.

After-sales Service

Warranty

- Please keep the included warranty in a safe place for future reference.

If you need repair during warranty period

- For repairs, please contact your local dealer.
(Please read the warranty carefully, some repairs may not be covered under the warranty.)

⚠ Attention *You may be charged if your repair is for any of the following reasons.

1. Trouble resulting from handling in a manner that is not specified in the "Operation Manual".
2. Trouble or damage due to the use of water other than municipal drinking water.
3. Trouble or damage due to natural disaster, such as, earthquake, fires or floods.
4. Dropping the product or damage caused during transportation.
5. Damage caused by use of improper voltage.
6. Replacement of consumable parts.
7. Replacement of spent electrode.
8. Trouble resulting from improper usage or failure to perform regular maintenance.
9. Trouble resulting from tampering or altering.
10. Trouble caused by sediment or lime scale deposits.

If you need to repair after warranty expiration

- Contact your local dealer. Repaire may be available upon request at purchaser' s expense.

Others

- If you have any questions about the product, please contact your dealer.
- For use with cold water only.
- Do not use with water that is microbiologically unsafe or of unknown quality without adequate disinfection before or after the system.

⚠ Warning



In no case should the product be modified, overhauled or repaired by purchaser, as fire or electrical shock could result.
Any consequences of such behavior shall not be compensated by the maker.

Enagic Co., Ltd

Echizenya Bldg. 7F, 1-1-6 Kyobashi
Chuo-ku, Tokyo 104-0031
TEL: +81 (3) 5205-6030
FAX: +81 (3) 5205-6035

Enagic Inc.

1-40-1, Hoshida-kita
Katano-city, Osaka 576-0017
TEL: +81 (72) 893-2290